

ISO 9001
CERTIFIED

Best Choice



Precision Dividers

Catalog No. 807R

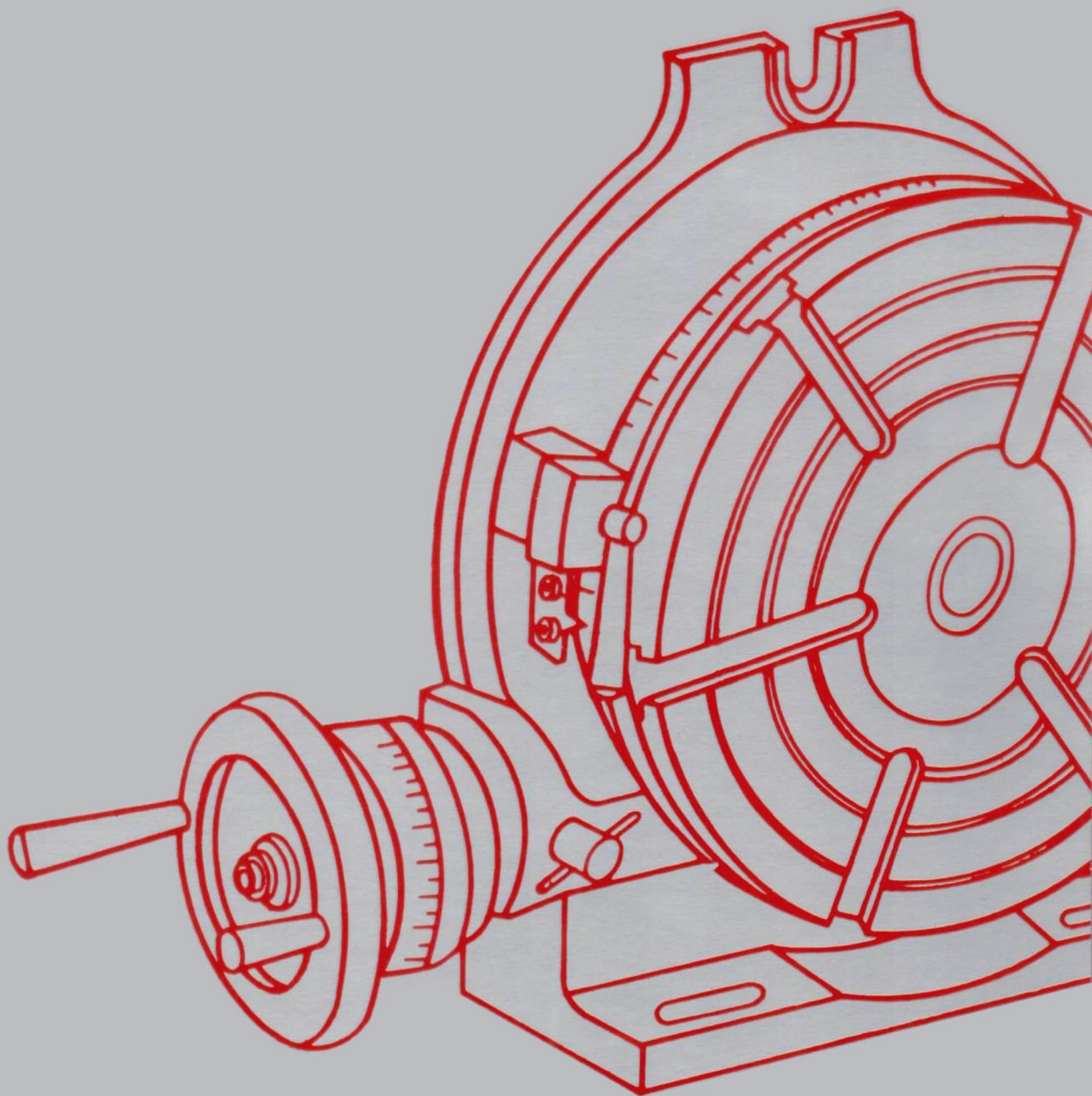

MANUFACTURER

Elephant Manufacturing (Jiangsu) Co., Ltd.

SUZHOU CHINA



HORIZONTAL/VERTICAL PRECISION ROTARY TABLES

FEATURES

- Works as an index center in the vertical position as well as a conventional rotary table for circular cutting, angle setting, boring and spot facing.
- The table is made of Meehanite. The base of the body, table surface and the rotating parts are finished ground, permitting very smooth rotation.
- Worm gear is hardened and ground.
- The ratio is 90:1. The work table is graduated a full 360° so that one turn of the handle moves the table through 4°. Micro collar is graduated in steps of 1' min. And vernier scale makes settings down to 10 seconds possible.
- These Rotary Tables are popular for their excellent performance, practical design and reasonable cost. They are widely used for circular cutting work, angle setting, boring, spot-facing and similar work.
- Used the key guide block, the center can be corrected both quickly and accurately.
- Heavy duty table clamp locks.
- Precision ground table face with morse taper sleeve.

ACCURACY	MAXIMUM VARIATION
Clamping surface flatness (concave)	.015m/m .0006"
Cylindrical center bore concentricity	.02m/m .0008"
Taper center bore concentricity	.02m/m .0008"
Surface to base parallelism	.02m/m .0008"
Surface to angle face squareness	.01m/m .0004"
Surface to center slot squareness	.02m/m .0008"
True running of center hole	
(1) Measured at hole eage	(1) .02m/m .0008"
(2) Measured at arbor 4" long	(2) .03m/m .0012"

INDEXING ACCURACY OF DIRECT INDEXING MECHANISM

Maximum cumulative spacing error
 6" & 8" Tables ; 1min 20sec.
 10", 12", & 14" Tables ; 45sec.

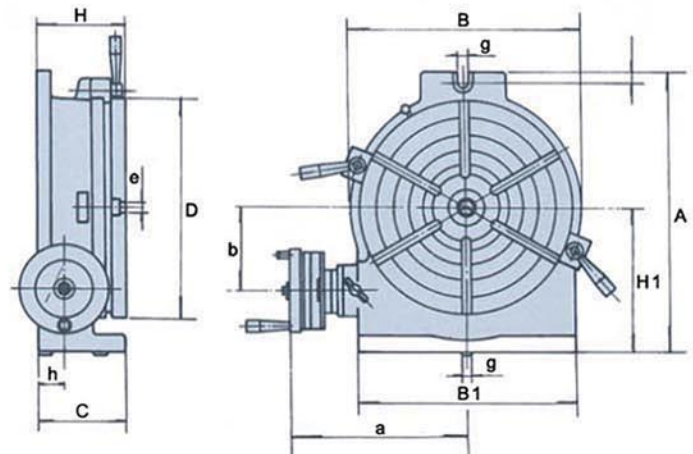

SPECIFICATIONS

Order No.	Model No.	Table		Center Height	Base Dimension			Width of T-Slot		Bolt Slot	Center Sleeve	Gross Weight Kgs / Lbs
		Outer Diameter	Height									
		D	H	H1	A	B	C	e	Type	g		
6075-04	ERT-HV4	110 4.33"	85 3.35"	81.5 3.21"	145 5.71"	114 4.49"	68 2.68"	12 0.47"	⊗	12 0.47"	MT-2	11 Kgs 24.2 Lbs
6075-06	ERT-HV6	150 5.91"	83 3.26"	100 3.94"	200 7.87"	160 6.30"	78 3.07"	12 0.47"	⊕	16 0.63"	MT-2	12.7 Kgs 27.9 Lbs
6075-08	ERT-HV8	200 7.87"	105 4.13"	135 5.31"	265 10.43"	220 8.66"	100 3.94"	14 0.55"	⊕	17 0.67"	MT-3	30 Kgs 66 Lbs
6075-10	ERT-HV10	250 9.84"	115 4.53"	165 6.50"	325 12.70"	280 11.02"	110 4.33"	14 0.55"	⊗	17 0.67"	MT-3	45 Kgs 99 Lbs
6075-12	ERT-HV12	300 11.81"	132 5.19"	195 7.68"	391 15.39"	330 12.99"	128 5.04"	16 0.63"	⊗	18 0.71"	MT-4	73 Kgs 160.6 Lbs
6075-14	ERT-HV14	350 13.78"	138 5.43"	230 9.06"	450 17.72"	390 15.35"	128 5.04"	16 0.63"	⊗	18 0.71"	MT-4	87 Kgs 192 Lbs
6075-16	ERT-HV16	406 15.98"	155 6.10"	255 10.03"	500 19.69"	430 16.93"	150 5.90"	16 0.63"	⊗	18 0.71"	MT-4	105 Kgs 231 Lbs



HORIZONTAL PRECISION ROTARY TABLES

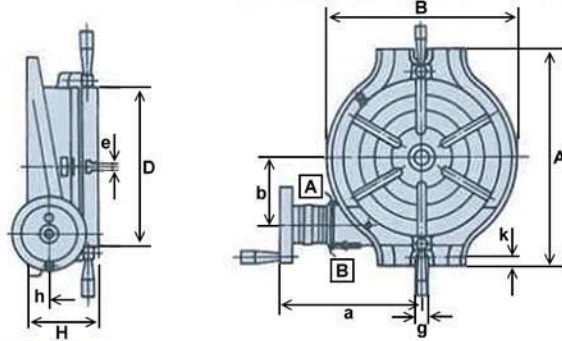

SPECIFICATIONS

Unit:mm/inches

Order No.	Model No.	Table		Base Dimension		Width of T-Slot		Bolt Slots	Center Sleeve	Worm Gear ratio	Gross Weight Kgs/Lbs
		Outer diameter	Height	A	B	e	Type				
6076-06	ERT-6	160 6.30"	75 2.95"	260 10.24"	196 7.72"	10 0.39"	⊕	12 0.47"	MT-2	90:1	19Kgs 41.8Lbs
6076-08	ERT-8	200 7.87"	80 3.15"	290 11.42"	238 9.37"	12 0.47"	⊕	14 0.55"	MT-3	90:1	30Kgs 66Lbs
6076-10	ERT-10	250 9.84"	90 3.54"	330 13"	286 11.26"	12 0.47"	⊗	14 0.55"	MT-3	90:1	41Kgs 90.2Lbs
6076-12	ERT-12	320 12.6"	110 11.33"	410 16.14"	360 14.17"	14 0.55"	⊗	18 0.71"	MT-4	90:1	72Kgs 158.4Lbs
6076-16	ERT-16	400 15.75"	400 5.51"	530 20.87"	450 17.72"	14 0.55"	⊗	18 0.71"	MT-4	90:1	129Kgs 283.8Lbs
6076-20	ERT-20	500 19.69"	158.5 6.24"	640 25.2"	560 20"	18 0.71"	⊗	22 0.87"	MT-5	90:1	225Kgs 495Lbs



Model No. ERT-10

Optional Accessories

A DIVIDING PLATES



Dividing Plate set includes index plate, crank handle, 3 pcs screw, sector, and U-washer.

Order No.	Model No.	Used of Model
6058-01	EDP-1	ERT-HV6 / ERT-6

Dividing Plates A, B, C

Number of the holes	A-Plate	15,16,17,18,19,20
	B-Plate	21,23,27,29,31,33
	C-Plate	37,39,41,43,47,49

Order No.	Model No.	Used of Model
6058-02	EDP-2	ERT-HV8,12,14 / ERT-8,10,12,14

Dividing Plates A, B

Number of the holes	A-Plate	26,30,34,38,41,44,47,51,57
		28,32,37,39,43,46,49,53,59
	B-Plate	61,67,71,77,81,87,91,97, 63,69,73,79,83,89,93,99

B TAILSTOCKS



ETS-1



ETS-2/ETS-3

Unit:mm/inches

Order No.	Model No.	Center Height		Used of Model
		Max.	Min.	
6059-01	EST-1	131 5.15"	97 3.81"	ERT-HV6
6059-02	EST-2	210 8.26"	130 5.12"	ERT-HV8,10,12
6059-03	EST-3	300 11.81"	210 8.27"	ERT-HV14,16

C FLANGES

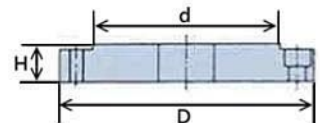

Order No.	Model No.	D	d	H	Used of Model
6057-00	EFLT-0	138	100	20	ERT-HV6,8 ERT-6,8
6057-01	EFLT-1	170	130	21	ERT-HV8,10 ERT-8,10
6057-02	EFLT-2	195	155	24	ERT-HV12,14,16 ERT-12,14,16
6057-03	EFLT-3	210	160	24	ERT-HV12,14,16 ERT-12,14,16

⊙ Any specifications may be changed without notice.



SEMI-UNIVERSAL DIVIDING HEADS

FEATURES

- Can be easily adjusted to any angle between 10° to $+90^{\circ}$ from a horizontal position.
- Hardened and ground spindle is rigidly held in a taper roller bearing.
- Divide any angle by the direct, indirect or differential methods.
- Spiral machining capability.
- All models have threaded spindle nose and 24 hole dividing plate with easy conversion to fast direct indexing on numbers 2,3,4,6,8,12, and 24.
- Hardened and ground worm gear has a 40 to 1 ratio.
- Positive locking mechanism uses a 360° brake shoe.
- Accurate precision, little back lash, fine appearance and strong structure so can assure smooth rotation.
- Three dividing plates are included.

Standard Accessories

- Dividing Plates A, B, C

Number of the holes	A-Plate 15,16,17,18,19,20
	B-Plate 21,23,27,29,31,33
	C-Plate 37,39,41,43,47,49

- Tailstock
- Flange Plate for 3-jaw chuck

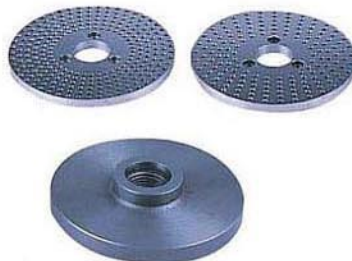

Optional Accessories

- 5" 3-jaw chuck for EBS-0
- 6" 3-jaw chuck for EBS-1



Model No. EBS-0



The state of
EBS-0 fitted with 5" 3-Jaw Chuck

THREAD SPINDLE: EBS-0 1-1/2"-8 TPI
EBS-1 1-1/2"-8 TPI

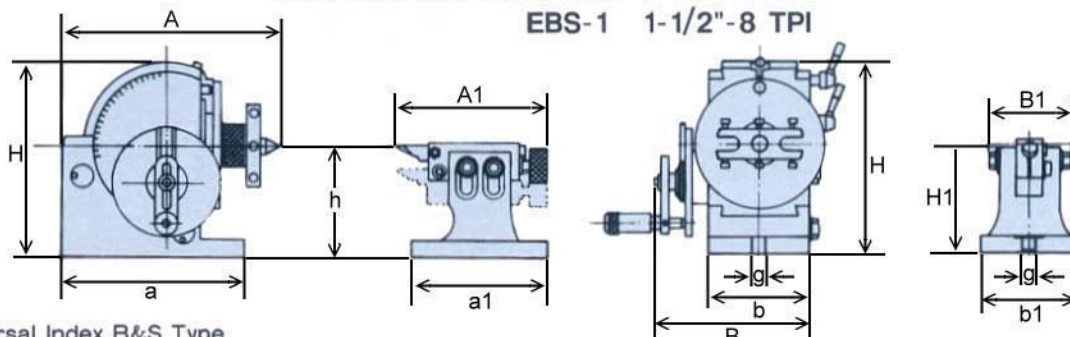

Semi-Universal Index B&S Type
No.0, No.1 (Head-stock)

Order No.	Model No.	A	B	H	h	a	b	g	Taper of center	Diameter of spindle hole
6060-00	EBS-0	193	131	173	100	166	90	16	MT-2 or	18
		7.59"	5.15"	6.81"	3.93"	6.53"	3.54"	0.63"	B&S No.7	0.71"
6060-01	EBS-1	242	168	220	128	206	113	16	MT-3 or	20
		9.52"	6.61"	8.66"	5.04"	8.11"	4.45"	0.63"	B&S No.9	0.79"

No.0, No.1 Tail-stock Unit:mm/inches

A ₁	B ₁	H ₁	h	a ₁	b ₁	g ₁	Weight Kgs / Lbs
175	87	102	100	130	92	16	23Kgs
6.89"	3.42"	4.02"	3.93"	5.12"	3.62"	0.63"	50.6Lbs
183	87	137	128	158	110	16	36Kgs
7.20"	3.42"	5.39"	5.04"	6.22"	4.33"	0.63"	79.2Lbs



UNIVERSAL DIVIDING HEAD

Standard Accessories



Model No. EBS-2

THREAD SPINDLE: 2-1/4"-8TPI

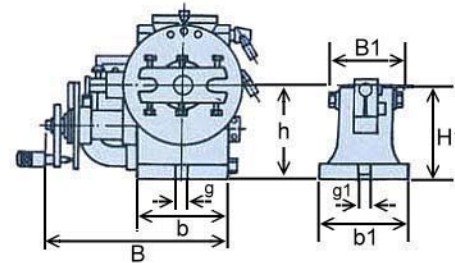
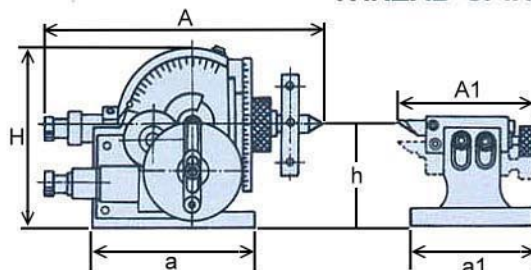

Universal Index B&S Type
No.2 (Head-stock)

No.2 Tail-stock

Unit:mm/inches

Order No.	Model No.	A	B	H	h	a	b	g	Taper of center	Diameter of spindle hole	A ₁	B ₁	H ₁	h	a ₁	b ₁	g ₁	Weight Kgs / Lbs
6060-02	EBS-2	370 14.56"	280 11.02"	236 9.29"	133 5.24"	212 8.35"	134 5.27"	16 0.63"	MT-4 or B&S No.10	25.4 1"	183 7.20"	87 3.42"	156 6.14"	133 5.24"	175 6.89"	122 4.80"	16 0.63"	73Kgs 161Lbs

ACCURACY

MAXIMUM VARIATION

Center concentricity		.015m/m .0006"
Inside taper concentricity of dividing spindle		
(1) Measured at spindle nose	(1) .01 m/m	.0004"
(2) Measured at arbor(8" long)	(2) .03 m/m	.0012"
Axial movement of dividing spindle		.01m/m .0004"
Alignment of dividing head and tailstock		
(1) Vertical plane	(1).02 m/m	.0008"
(2) Horizontal plane	(2).02 m/m	.0008"
DIVIDING ACCURACY OF WORM DRIVE		
Maximum cumulative spacing error		1' 30"

Optional Accessories

- 6" 3-jaw chuck for EBS-2
- 8" 3-jaw chuck for EBS-2

Optional 3-Jaw Chucks

Order No.	Model No.	Applicable Chuck
6060-00	EBS-0	4" or 5"
6060-01	EBS-1	5" or 6"
6060-02	EBS-2	6" or 8"

⊙ Any specifications may be changed without notice.



HORIZONTAL/VERTICAL SUPER INDEXING SPACERS

FEATURES

- Solid Meehanite casting, specially designed for milling, drilling and boring.
- Hardened and ground 24 position master plate.
- Hardened and ground worm gear.
- Precision ground steel spindle.
- Heavy duty shoe type spindle brake ensuring maximum rigidity for milling cuts.
- 360° Graduated ring.
- Chrome plated graduated ring with five minute vernier reading.
- The center through hole is big to be suitable for the large and long workpiece.
- Used the key guide block, the center can be corrected both quickly and accurately.
- Eccentric worm housing for spindle disengagement.
- When the chuck is removed the unit can be used as a horizontal and vertical type rotary table.
- The operating handle to rotary table worm gear reduction ratio is 1:90.
- Horizontal and vertical mounting positions.

Standard Accessories

- 3-jaw chuck
- Six masking plates (2,3,4,6,8 & 12 position)
- T-slotted face plate (8" or 10")

ECS-6 ECS-8	of ACCURACY	TOLERANCE (Max.)
Parallelism of table surface to base		.015m/m .0006"
Axial movement of table surface		.015m/m .0006"
True running of center boss		.01m/m .0004"
Squareness of base to angle face per 12"		.02m/m .0008"
Positioning accuracy		45 sec.



SPECIFICATIONS

Unit:mm/inches

Order No.	Model No.	Chuck				Face Plate	
		Outer Dia.	Thru Hole Dia.	Inner Jaw	Outer Jaw	Outer Dia.	Thickness
6080-06	ECS-6	160 6.30"	40 1.57"	3~55 0.12~2.17	55~145 2.17~5.71	205 8.07"	40 1.57"
6080-08	ECS-8	200 7.87"	65 2.56"	4~85 0.16~3.35	65~200 2.56~7.87	254 10"	42 1.65"

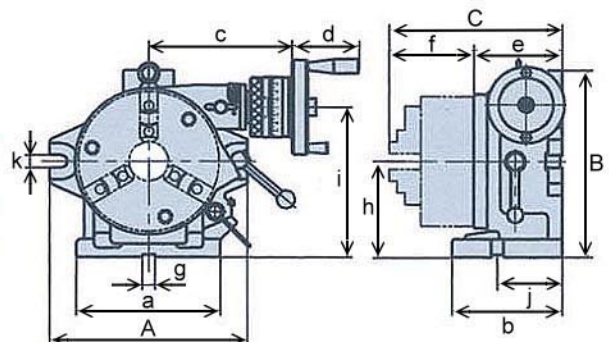

Model No.	Guide Block	Turret Hole Dia.	A	B	C	a	b	c	d	e	f	g	h	i	j	k	Gross Weight kgs/lbs
ECS-6	16 0.63"	50 1.97"	250 9.84"	238 9.37"	207 8.15"	182 7.17"	140 5.51"	186 7.32"	93 3.66"	112 4.41"	65 2.56"	16 0.63"	122 4.80"	191 7.52"	80 3.15"	16 0.63"	43Kgs 95Lbs
ECS-8	16 0.63"	63 2.48"	320 12.60"	294 11.57"	235.5 9.27"	230 9.06"	160 6.30"	213 8.39"	93 3.66"	126.5 4.99"	75 2.95"	16 0.63"	155 6.10"	234.67 9.24"	95 3.74"	20 0.79"	72Kgs 158.4Lbs

⊙ Any specifications may be changed without notice.



HORIZONTAL/VERTICAL BASIC INDEXING SPACERS

FEATURES

- Solid Meehanite casting, specially designed for milling, drilling and boring.
- Hardened and ground 24 position master plate.
- Precision ground steel spindle.
- Heavy duty shoe type spindle brake ensuring maximum rigidity for milling cuts.
- 360° graduation ring.
- Chrome plated graduated ring with five minute vernier reading.
- The center through hole is big to be suitable for the large and long workpiece.
- Used the key guide block, the center can be corrected both quickly and accurately.
- Horizontal and vertical mounting positions.

Standard Accessories

- 3-jaw chuck
- Six masking plates (2,3,4,6,8 and 12 position)

ECC-6 ECC-8	of ACCURACY	TOLERANCE (Max.)
Parallelism of table surface to base		.015m/m .0006"
Axial movement of table surface		.015m/m .0006"
True running of center boss		.01m/m .0004"
Squareness of base to angle face per 12"		.02m/m .0008"
Positioning accuracy		45 sec.



Model No. ECC-8

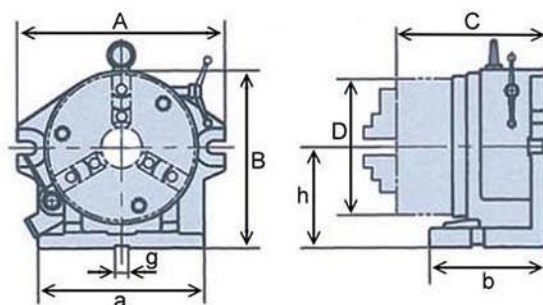

SPECIFICATIONS

Unit:mm/inches

Order No.	Model No.	Chuck				Guide Block	Turret Hole Dia.	A	B	C	D	a	b	h	Gross Weight kgs/lbs
		Outer Dia.	Thru Hole Dia.	Inner Jaw	Outer Jaw										
6081-06	ECC-6	160 6.30"	40 1.57"	3~55 0.12~2.17"	55~145 2.17~5.71"	16 0.63"	50 1.97"	255 10.04"	225 8.86"	152 5.98"	160 6.30"	190 7.48"	115 4.53"	130 5.12"	32Kgs 70Lbs
6081-08	ECC-8	200 7.87"	65 2.56"	4~85 0.16~3.35"	65~200 2.56~7.87"	16 0.63"	63 2.48"	320 12.60"	272 10.71"	174 6.85"	200 7.87"	230 9.06"	154 6.06"	154 6.06"	52Kgs 114Lbs

Optional Accessories

A DIVIDING PLATES



Order No.	Model No.	Used of Model
6058-02	EDP-2	ECS-6, ECS-8

B TAILSTOCKS



ETS-1

ETS-2

Unit:mm/inches

Order No.	Model No.	Center Height		Used of Model
		Max.	Min.	
6059-01	ETS-1	131 5.15"	97 3.81"	ECS-6, ECC-6
6059-02	ETS-2	210 8.26"	130 5.12"	ECS-8, ECC-8

⊙ Any specifications may be changed without notice.



HORIZONTAL/VERTICAL SUPER SPACERS

FEATURES

- Solid Meehanite casting, specially designed for milling, drilling, boring and related machining operations.
- Simple and compact construction provides for 2 types of dividing.
- Angular indexing can be performed through the graduation ring from 0° to 360° in increments of 1°.
- Catch device allows you to perform basic indexing in divisions of 2,3,4,6,8,12 & 24 without changing masking plates.
- Horizontal and vertical mounting positions.

Standard Accessories

- 3-jaw chuck
- Locating keys

Optional Accessories

TAILSTOCK

Unit:mm/inches

Order No.	Model No.	Center Height		Used of Model
		Max.	Min.	
6059-01	ETS-1	131 5.15"	97 3.81"	ECCP-6
6059-02	ETS-2	210 8.26"	130 5.12"	ECCP-8, ECCP-12

ACCURACY	TOLERANCE (Max.)
Parallelism over face	.02m/m .0008"
Squareness (base to chuck)	.02m/m .0008"
Concentricity of chuck	.038m/m .0015" TIR
Center hole concentricity	.02m/m .0008" TIR
Mounting flange concentricity	.02m/m .0008" TIR
Indexing accuracy	45 sec.

SPECIFICATIONS

Unit:mm/inches

Order No.	Model No.	Chuck Dia.	A	B	C	D	Thru Hole Dia. d	E	F	G	H	I	Weight kgs lbs
6082-06	ECCP-6	160 6.30"	125 4.92"	301 11.85"	210 8.27"	160 6.30"	42 1.653"	14 0.55"	140 5.51"	14 0.55"	220 8.66"	245 9.65"	34 75
6082-08	ECCP-8	200 7.87"	160 6.30"	382 15.04"	265 10.43"	200 7.87"	55 2.165"	18 0.71"	160 6.30"	18 0.71"	232 9.31"	300 11.81"	62 137
6082-12	ECCP-12	315 12.40"	250 9.84"	555 21.85"	412 16.24"	315 12.40"	103 4.055"	18 0.71"	200 7.87"	18 0.71"	311 12.24"	400 15.75"	140 308

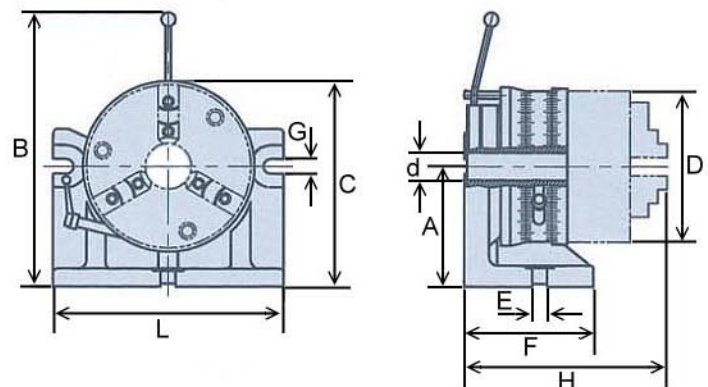
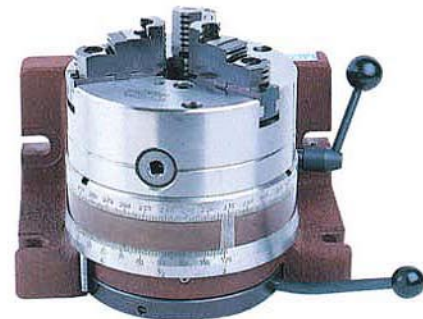

⊙ Any specifications may be changed without notice.

2020R



HORIZONTAL/VERTICAL SUPER DIVIDER

FEATURES

- The total operating process can be completed by using the Operating Bar.
The procedure is "unclamp"- "divide"- "restore" the Operating Bar Automatic clamping. Which can be completed in one step.
- The Super Divider has more clamping force than that of a conventional Divider.
- When dividing is required, turn the select Pin located near the driver.
- The Super Divider is a new design for smooth efficient operation.
- The Super Divider has a dividing capability of 2,3,6,8,12,24 equal parts and unequal dividing in 15 units

THE DIVISION ARE EASILY AND QUICKLY SET BY SIMPLY TURNING THE SELECTOR PINS THROUGH HALF A TURN WITH A SCREWDRIVER.

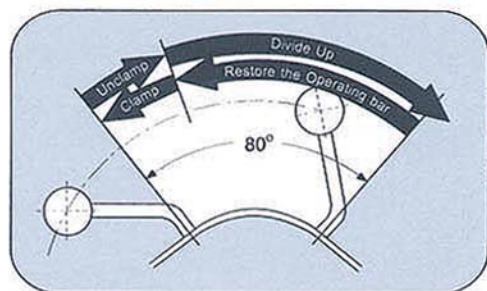
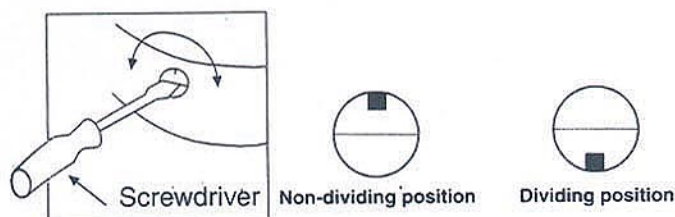

Model No. ESD-7

Optional Accessories

- 7" 3-jaw chuck

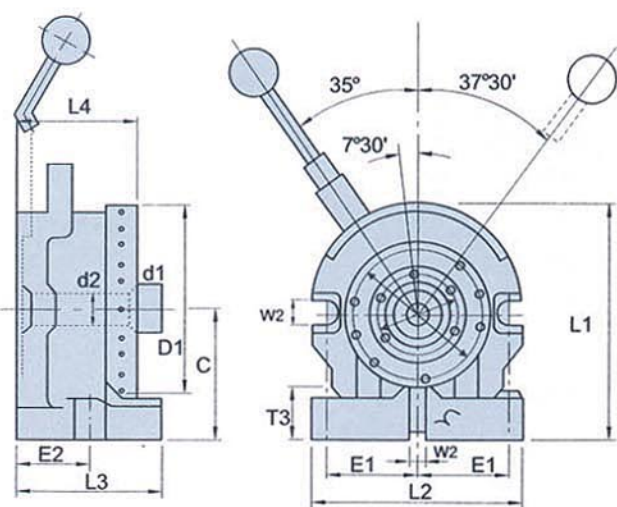

SPECIFICATIONS

Unit:mm/inches

Order No.	Model No.	C	D1	D2	D3	d1	d2	E1	E2	L1	L2	L3
6055-07	ESD-7	135 5.32	192 7.56	172 6.77	115 4.53	70 2.76	56 2.20	117.5 4.63	70 2.76	265 10.43	260 10.24	160 6.30

Model No.	Internal Dia.	Permissible Load	L4	R1	R2	T1	T2	T3	W1	W2	Weight kgs/lbs
ESD-7	56 2.20 Max.	50 110 Max.	115 4.53	280 11.02	140 5.51	6 .24	7 .28	22 .87	16 .63	16 .63	32 70

⊙ Any specifications may be changed without notice.

2020R



HORIZONTAL/VERTICAL RAPID INDEXER

FEATURES

- Extremely fast and accurate indexing.
- Accepts a standard 5c collet or 5" 3-jaw chuck.
- 4 Positions provide for either 15°, 30°, 40°, 60° divisions.

Center Height-----3.937" (100m/m)

Terminal "A" provides 6 positions 60° each respectively
Terminal "B" provides 8 positions 45° each respectively
Terminal "C" provides 12 positions 30° each respectively
Terminal "D" provides 24 positions 15° each respectively



Model No. **E5CQ**

Shown with optional
5" 3-jaw chuck

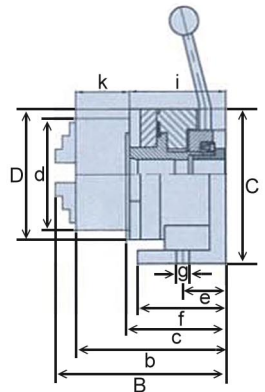
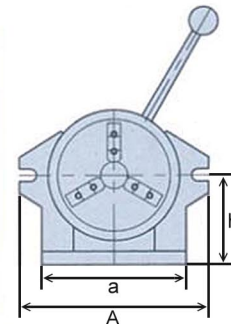

ACCURACY	MAXIMUM VARIATION
Concentricity	.01m/m .0004"
Parallelism	.02m/m .00078"
Squareness	.02m/m .00078"
Indexing accuracy within 2 minutes	

Optional Accessories

- 5" 3-jaw chuck
- Adjustable tailstock

SPECIFICATIONS

Unit:mm/inches

Order No.	Model No.	A	B	C	D	a	b	c	d	e	f	g	h	i	k	Weight kgs/lbs
6050-01	E5CQ	210 8.27"	193 7.60"	180 7.09"	144 5.67"	156 6.14"	167 6.57"	104 4.09"	125 4.92"	46.5 1.83"	98 3.86"	14 0.55"	98.2 3.87"	107 4.21"	60 2.36"	11.6 Kgs 25.2 Lbs

5C SPIN INDEX FIXTURE

FEATURES

- A multi-purpose indexing fixture designed to extend the work capabilities of surface grinders, drill presses and all types of milling machines.
- Accepts 5C collets to 1-1/8" Capacity
- Indexing Plate with precise 36 hole pattern
- Vernier Setting to 1°
- Spindle Travels 2-5/16" for flute grinding
- Hardened and Ground spindle with lock.



Model No. **E5CS**
Order No. **6050-02**

ACCURACY	MAXIMUM VARIATION
Cylindrical center bore (per 1")	.03m/m .0012"
Dividing spindle concentricity	.01m/m .0004"
Spindle center line parallelism to base	.02m/m .0008"
Base ground parallel to within	.013m/m .0005"

© Any specifications may be changed without notice.